



# HEPA 500 AIR SCRUBBER



## WHAT IT DOES:

The HEPA 500 is a powerful air scrubber for removing dust and other particles from construction and remodeling sites. Use during demolition, sanding, carpet tearout or any other project that generates dust. Also use to clean air for occupants with asthma or allergies. When used with the optional Carbon Filter, the unit can also remove odors from paint, varnish, dead animals and more. Also useful for providing clean air to enclosed spaces.

## WHEN TO USE:

- Any time dust is likely to be present: remodels, reconstruction, sanding floors, carpet replacement, deep cleaning, etc.
- Especially useful in environments when persons with allergies or asthma are present.
- One unit can effectively treat up to 1000 cubic feet of enclosed space.
- Built-in electrical sockets allow for up to three units to be “daisy” chained from one outlet for up to 3000 cu. ft. of air scrubbing.

## HOW TO USE:

For optimum filtration, make sure your customer is equipped with adequate replacement filters. Follow the application table below to determine the best solution for your customer's needs.

**TIP:** When used with the optional carbon filter (F397), the HEPA 500 can effectively remove odors caused by paint, varnish, dead animals, sewer and more.

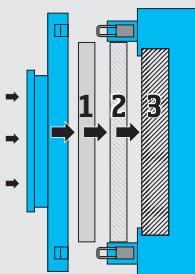

FILTERING NEEDS	FILTER #1	FILTER #2	FILTER #3 (HEPA)
<b>Dust removal or basic air scrubbing</b> on construction or remodeling sites.	Stage One Pre-Filter (F270)	Stage Two Pre-Filter (F271)	HEPA filter (F321 or F513)
<b>Odor control plus air filtration</b> to remove food odors, fumes from paint, varnish and paint thinners, sewer odors, dead animals and many other noxious odors.	Activated Carbon Filter (F397)	Stage Two Pre-Filter (F271)	HEPA filter (F321 or F513)



**RENTER SHOULD ALWAYS REMOVE, BAG AND DISPOSE OF ALL FILTERS BEFORE RETURNING HEPA 500 TO HOME DEPOT**

## OPERATING THE HEPA 500

- 1 Unwrap cord and plug unit into suitable outlet.
- 2 Remove front opening cap
- 3 Press switch to **ON** position. **ADJUST** for desired airflow with control knob. Use higher speeds for larger spaces or heavy amount of dust in air.
- 4 Turn off and unplug unit when moving the unit or changing filters
- 5 Equipped with circuit breaker. If tripped, press Reset switch.

See Owner's Manual for important safety information and operating instructions.

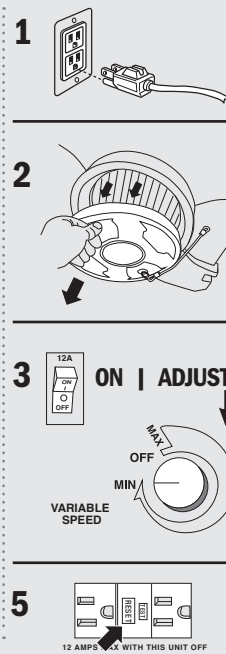

PROUDLY  
BUILT IN USA



Go to **HD.drieaz.com**  
for instructional videos and user guides.  
Or call **800-932-3030** for technical support

